

Ø 7.13

Aerospace alloy  
356AT-6, 4th Axis CNC  
machined top  
and bottom!

.062 wall  
6061T6  
seamless tube

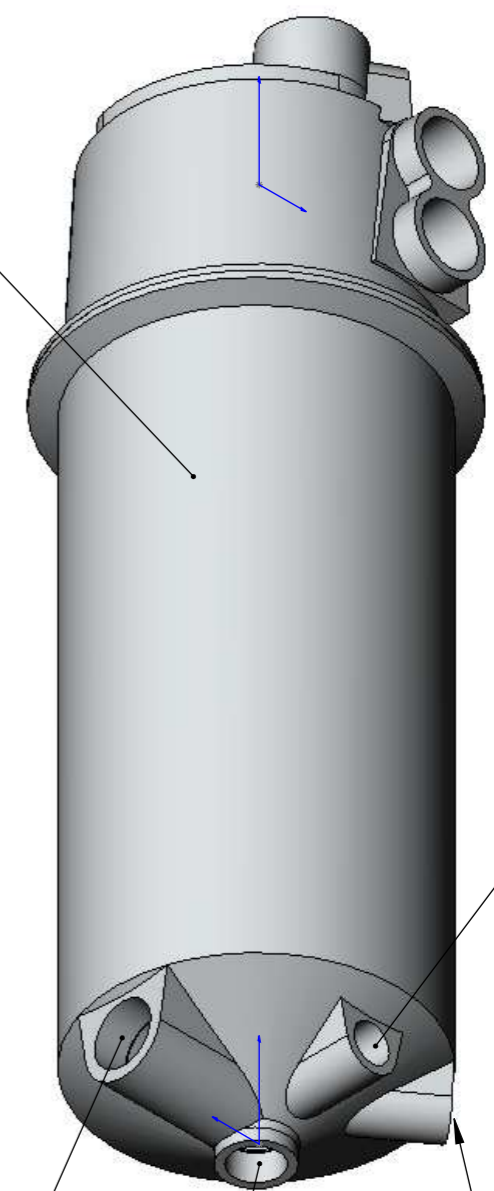

12 mm  
Temp.  
sender  
boss

1/2 NPT  
Heater  
boss

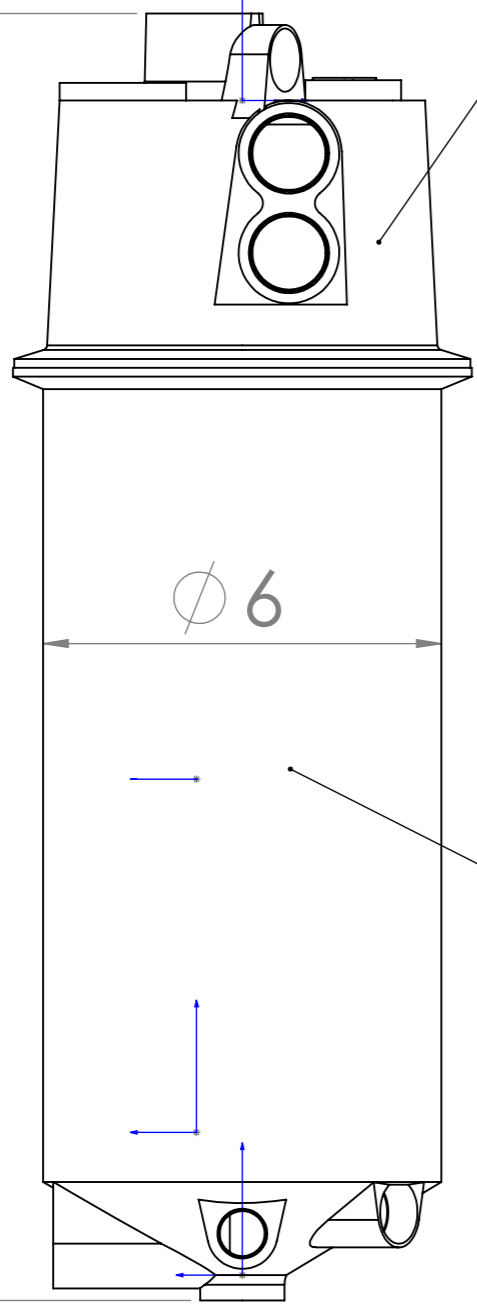

20.10

Ø 6

New 7007-A  
Tanks available  
in any height!

Optional -6

Vent to  
engine

Filler  
Oil level  
check cap

1/4 20 Tank  
mount boss  
( Z06 )

Spintric air  
relief in

-12 Scavenge  
return

-12 Oil supply

-10 Oil drain

Part #	#7007-A	
TITLE:	A R E DRYSUMP WWW.DRYSUMP.COM	
DWG NO.	Assembly Cast tank	A3
SCALE:1:5	SHEET 1 OF 1	